

a When you have secured baby in the carrier, adjust the carrier so that baby is high on your chest.

Gently lift baby with one hand and pull on the end of your shoulder strap, and repeat on the other side.

Make sure that the plastic Infantino strap holder is between the bottom of your shoulder blades.

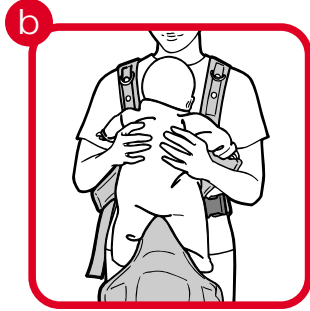

b To take baby out, simply open up one side of the carrier (unfasten side openings, unhook head support from your shoulder strap) and slide baby out.

To remove a sleeping baby: Unhook the head support on both sides. Slide one hand into the carrier and hold baby against your chest. Use your other hand to unfasten the buckles and Velcro® at the side openings. The carrier's front will now fall forward, and you can put your baby down without waking baby up!

Hint: This is a great way to remove a facing-out baby and transfer him or her to dad, grandma, etc. Follow the above steps to release the front of the carrier, and hand-off is easy!

IMPORTANT! Check frequently to make sure that your baby's head and body are in an upright position in the carrier. Baby's chin should not point down toward baby's chest. Baby should only face out when he or she can support own head and is awake! Your baby must face you until he or she can hold head and shoulders up without assistance.

WARNINGS: Your baby must face you until he or she can hold head and shoulders up without assistance. This carrier should NOT be used to carry a baby on your back. It is only intended for use by adults while walking or standing—never use this carrier while running, biking, jogging, or operating any type of motorized vehicle.

Do not bend at the waist when leaning down—always bend at the knees to make sure that baby stays securely in carrier.

Never leave baby unattended. Carrier is not designed for holding child in motor vehicles and should not be used in place of a car seat that meets federal motor vehicle safety standards.

This carrier is subject to normal wear and tear during use. Before each use, carefully inspect the carrier for any signs of loose seams, tears or separation, or broken hardware.

Before returning this carrier to the store for any reason, let us try to help you!
Please call us toll-free at 1-800-840-4916.

Please carefully review these instructions and cautions. Keep for future reference.

It is our mission to brighten every child's early years and to enhance the parenting experience by creating safe, innovative accessories and toys.

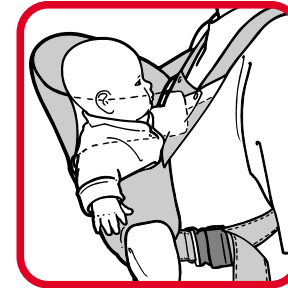

There should always be room between your baby's face and your chest to provide a clear source of air.



If baby falls asleep, turn baby's face to the side to provide an unobstructed source of air.

bēbē style™

The Versatile & Stylish Carrier

Thank you for choosing an Infantino carrier!

We believe that the Bēbé Style is the most comfortable and stylish way to carry your baby! Important features like a versatile, wrap-around head support and an easy-to-use seat height adjustment system make it easy to create a perfect fit for your little one. Simply open the carrier front to remove your sleeping baby!



Putting on carrier

IMPORTANT! Always put carrier on your body before putting in baby!

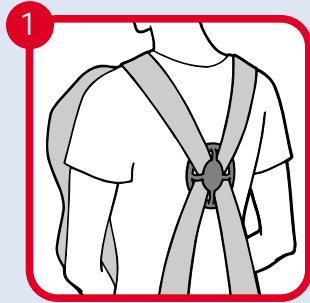

- 1 Unbuckle the adult shoulder straps and slip the carrier over your head. The carrier's front opening should be against your chest (see illustration 1) and the plastic Infantino strap holder should be between the bottom of your shoulder blades.

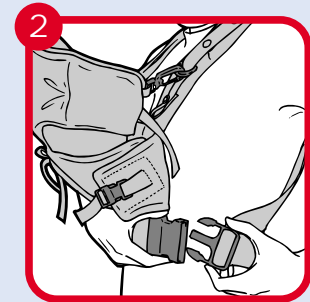

- 2 Fasten the buckles at the end of your shoulder straps to each side of the carrier. Pull the ends of the shoulder straps until the carrier fits snugly against your body.

Putting baby in — facing in

Your new baby needs lots of close contact and attention! The Bébé Style's facing-in position is the perfect way to keep your little one cuddled against you. The wrap-around head support cradles baby's head and neck and even provides support when baby falls asleep! You can entertain and bond with your baby by talking, touching, playing, and making eye-contact—and still have your hands free to get things done!



- 3 Open up one side of the carrier for easy baby-entry! Unfasten the hook from the loop on your shoulder strap. Unbuckle the side of the carrier and detach Velcro®. Carefully slide baby into the carrier through the side opening.

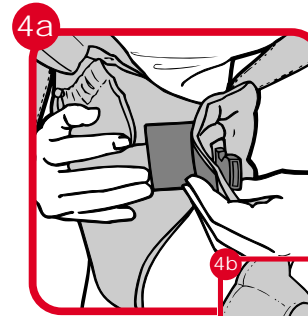

- 4a Fasten the Velcro® and buckle to close side opening.

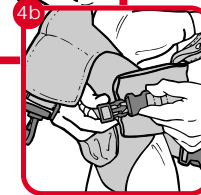

- 4b Make sure that the Velcro® has been closed snugly at baby's sides. Make sure that buckles are secured over Velcro® side openings.

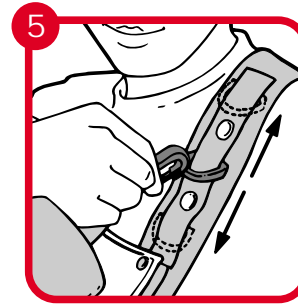

- 5 Attach the hook at the end of the head support to the loop on your shoulder strap. To adjust seat height, simply support baby's weight with one hand and move hook up or down on your shoulder straps. Fasten snaps to set the desired seat height.

Hint: Moving the loop up will raise the carrier for a smaller baby. Moving the loop down will allow more room for a bigger baby.

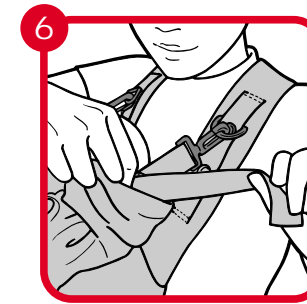

- 6 Adjust the head support by pulling on or releasing the head support strap. This will allow you to adjust the amount of distance between you and your baby.



- 7 When your baby can support his or her own head, you can fold down the head support. This will allow your little one to face you and socialize, turn around and explore the surroundings! Flip up the head support to support baby's head if he or she gets sleepy!

Putting baby in — facing out

When your little one is a few months old and can fully support his or her own head, it is time to explore! The Bébé Style's facing-out position lets baby have the best of both worlds—being held by you AND checking out the things that are going on all around you!

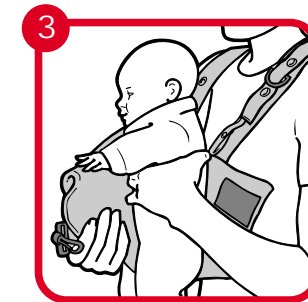

- 3 Simply fold down head support and place baby in carrier, facing forward. (Follow the same steps for putting your baby in the carrier facing-in.) Adjust the head support straps so that baby's back is snugly against your chest. Baby should not lean forward.



- 4 A smaller baby's arms should be through the arm holes—see illustration. A bigger baby's arms will rest comfortably over the sides of the head support.

IMPORTANT! If baby falls asleep in the facing-out position, immediately remove baby from carrier and put baby back in facing-in position.